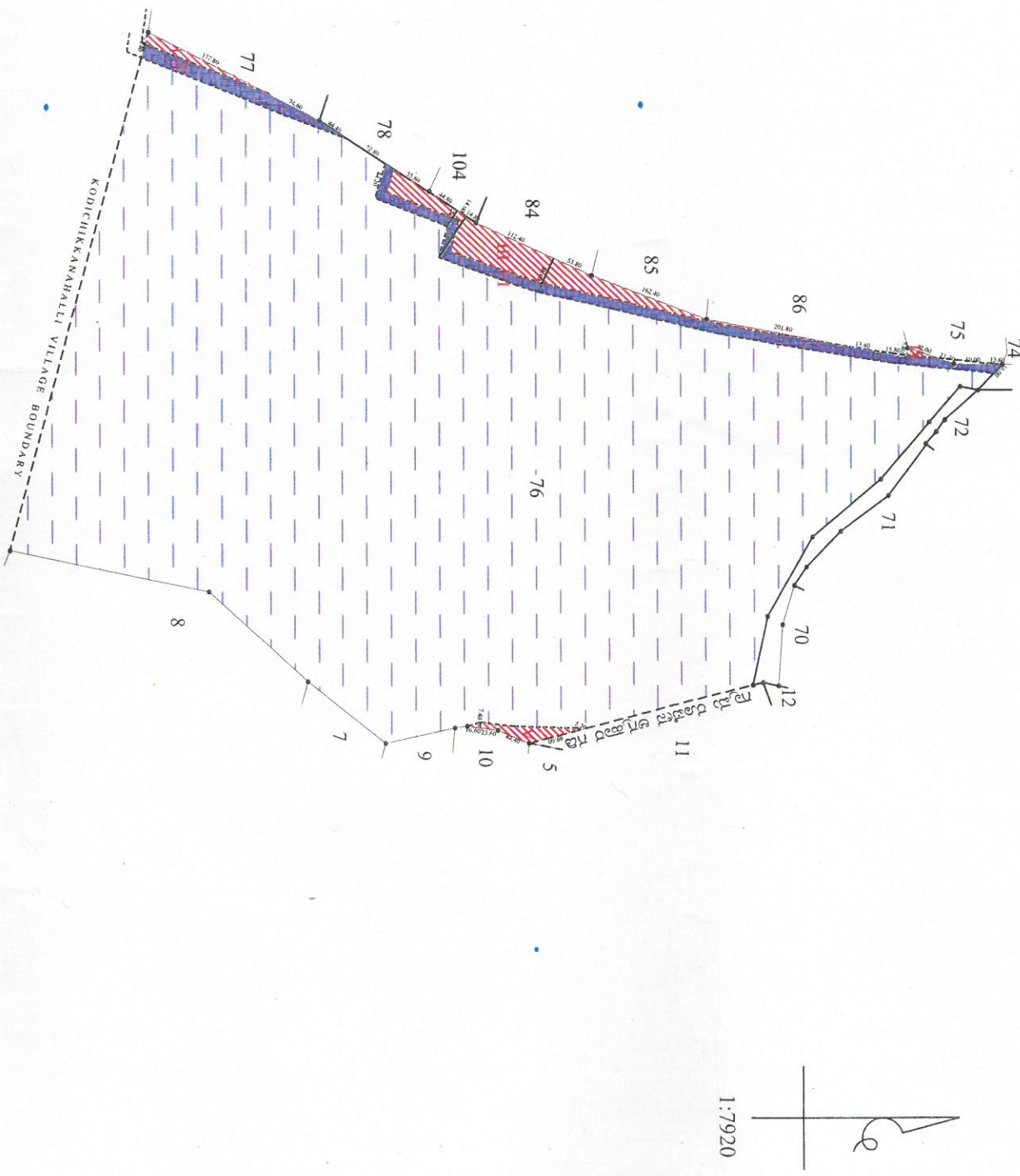

Madiwala Survey Number: 76Lake Sketch prepared, as per the Order of HONBLE HIGH COURT vide W P NO: 38401/2014(PIL) C W WRIT
APPLICATION NO:-11044/2018 DATE:- 04-09-2023

DETAILS:-

1. Sketch prepared, as per the directions of DDLR letter NO: ಜಿಎಂಎ/ಭೂಲನಿ/ತಾಂ(6)ವಿವ:21/2020-21, ದಿ:20-09-2023, memo of ADLR, Bangalore South ಭೂ.ನ.ನಿ/(ಪ್ರೇ)ಇತರ/273/2023-24, ದಿ:09-01-2024,
2. Color Shows Private encroachment details.
3. Color Shows Government encroachment details.
3. Survey department (land records) is only responsible for measurement and extent of the lake
4. The measurement carried as per survey records out in presence of B.B.M.P. Engineer revenue inspector, village accountant,
5. Lake details as before (the details of the encroachment in lake are need to be verify from concerned authority)

SL.NO. LAKE SNO	EXTENT OF THE LAKE		BLK NO.	DETAILS OF THE ENCROACHMENT IN LAKE			VACANT LAND (A-G)	TOTAL AREA	REMARKS
	AS PER AKHARABAND (A-G)	AS PER MEASUREMENT (A-G)		PRIVATE ENCROACHMENT TYPE OF ENCROACHMENT	Extent (A-G)	GOVT 1:1584 TYPE OF ENCROACHMENT			
1 76	166-39	166-39	I	Residential	00-14	Road		161-16	Around 52 Buildings were Encroached by Private people
			II			Road	01-03		
			III	Residential	03-01				
			IV	Residential	00-02				
			V	Residential	00-16				
			VI			Road	02-27		

ಬೂಮಿಮಾಪಕರು
ಬೆಂಗಳೂರು ದಕ್ಷಿಣ ತಾಲ್ಲೂಕು

ಆಯಾಕಾರದ
ಮಾಪಕರು
ಬೆಂಗಳೂರು ದಕ್ಷಿಣ ತಾಲ್ಲೂಕು
ಬೆಂಗಳೂರು ನಗರ.

ಆಯಾಕಾರದ
ಮಾಪಕರು
ಬೆಂಗಳೂರು ದಕ್ಷಿಣ ತಾಲ್ಲೂಕು,
ಬೆಂಗಳೂರು.

VILLAGE:- MADIWALA

HOBLI:- BEGURU

TALUK:- BANGALORE SOUTH

SKETCH SHOWING LAKE IN SURVEY NUMBER 76 AND 30MTRS BUFFER AREA ALL AROUND THIS LAKE.

30 Meter Buffer Zone From Lake Boundary is Demarked as per the order of the Honorable High Court Vide WP 38401/2014(PIL) Date :-02-06-2021



1. Sketch Prepared, As Per The Direction Of DDLR Letter No. ಜಿ.ತಾಂ.ಸ/ಭೂ.ಲ.ನಿ/ತಾಂ(6) ಎ.ಪ: 21/2020-21 Date : 28-06-2021

And Memo Of ADLR , Bangalore South Taluk Vide No.ಭೂ.ಸ.ನಿ./ಪಿ.ಆರ್/ಇತರೆ: 273/2021-22 ದಿನಾಂಕ:

2. ——— Line Shows The Boundary Of The Lake

3. - - - - - Line shows boundary of 30 Meter buffer zone area from the boundary of the lake

4. Survey department (land records) is only responsible for measurement and extent of the lake

5. The measurement carried as per available survey records in presence of Engineers of lake development division in BBMP, concerned Revenue

Inspector & Village Accountant administration officer of Revenue department

6. Buffer Zone Details mention as Below

Lake SY NO	Akharaband Extent (A-G)	Lake Name	The Area With In The 30M Buffer Zone			SY . NO Details In Buffer Zone	Remarks
			Index	Details	Extent (A-G)		
76	166-39	MADIWALA		Developed Area utilised by Private	15-35	MADIWALA 74,75,72,71,70,12,86,85,84,104,78,77 RUPENA AGRAHARA 11,5,10,9,7,8 KODICHIKKANAHALLI 11,5,10,9,7,8	
				Developed Area utilised by Public Use	03-35		
				Lake Area	07-33		
Total Buffer zone Extent					27-23		

Signature
ಬುಲಿಯಾಪಕರು
ಬೆಂಗಳೂರು ದಕ್ಷಿಣ ತಾಲ್ಲೂಕು

Signature
ಶಬ್ದೇಶಿಯಲ್ಲಿ ಪರಿಶೀಲಿಸಿದ
23/8/2021
ಬೆಂಗಳೂರು ದಕ್ಷಿಣ ತಾಲ್ಲೂಕು
ಬೆಂಗಳೂರು ನಗರ

Signature
ಫಲಾನುಭವಿಗಳ ಸಹಾಯಕ ನಿರ್ದೇಶಕರು,
ಬೆಂಗಳೂರು ದಕ್ಷಿಣ ತಾಲ್ಲೂಕು,
ಬೆಂಗಳೂರು.