

Deepanjali Lake

VILLAGE: DEEVATIGE RAMANAHALLI

HOBLI: KENGERI,

TALUK: BANGALORE SOUTH.

SURVEY NO: 32 LAKE

Lake Sketch Prepared As per the Order of Honorable High Court Vide No: WP NO:38401 / 2014 PIL Dated:02/06/2021

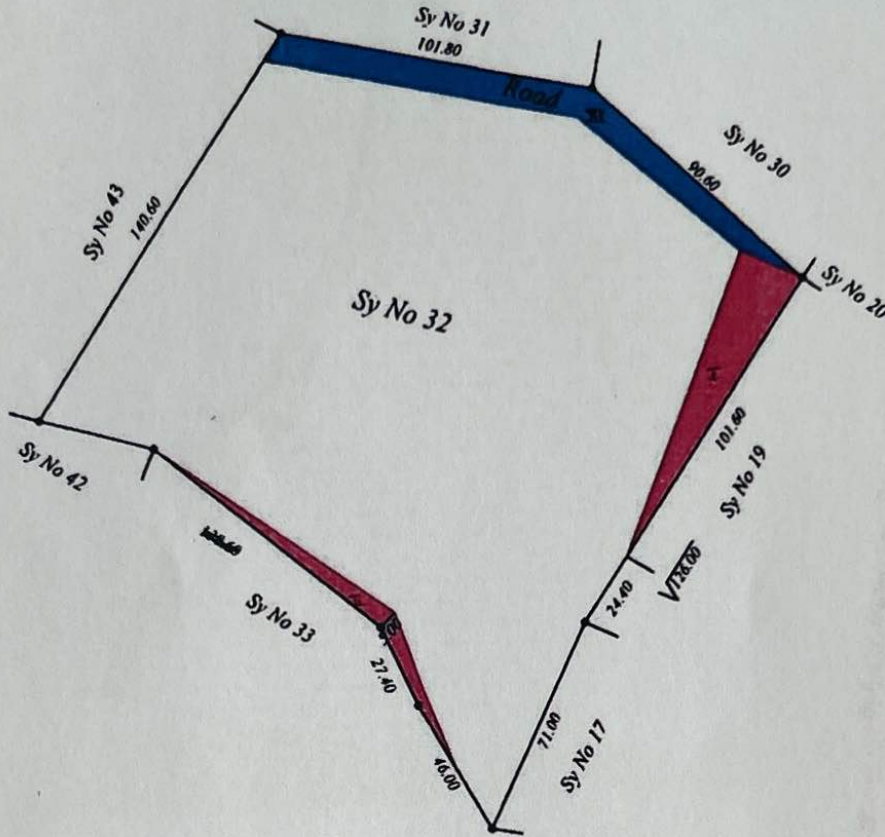

DETAIL:-

1. Sketch Prepared As per the direction of DDLR Letter No: ಜತಾಂಸ/ಭೂಲನಿ/ತಾಂ(6)ಎವ/21/2021 ದಿನಾಂಕ:28/06/2021 and memo of ADLR Bangalore South No: ಭೂಸನಿ/ಪ.ಆರ್/ಇಕರೆ:273/2020-21 ದಿನಾಂಕ:02/05/2024
2. Color Shows the Pravite lay out Road encroachment details.
3. Color Shows the privet encroachment details.
4. Survey Department(Land Records) is only responsible fo measurement and extent of the lake.
5. The measurement carried out as per Survey Records in presence of BBMP Engeenier
6. As fencing of the Lake boundary is alreadydone by the BBMP as per previous survey sketch during present field inspection that fence (Chain and Link Fencing) is still in extent only leftout area of the Lake is now demarketed as as encroachment as per Survey document.
7. Lake Details as below (The Details of the Encroachment in lake are need to be verify from conserved authority)

SL No	LAKE SY NO	EXTENT OF THE LAKE		DETAILS OF THE ENCHROCHMENT IN LAKE						Total Area of Encroachment (A-G)	VACANT LAND (A-G)	TOTAL AREA	REMARKS
		AS PER AKHARABAND (A-G)	AS PER MEASUREMENT (A-G)	PRAVITE ENCHROCHMENT			GOVT ENCHROCHMENT						
				Block No	TYPE OF ENCHROCHMENT	EXTENT (A-G)	Block No	TYPE OF ENCHROCHMENT	EXTENT (A-G)				
1	22	7-92	7-92	I	Factory Sheds	0-11	II	Road	0-16	1-2072	6-314	7-92	

Measurement Carried Date:

[Signature]
ಭೂಮಾನಂದ 20/06/24
ಬೆಂಗಳೂರು ದಕ್ಷಿಣ ತಾಲ್ಲೂಕು.

ಕಛೇರಿಯಲ್ಲಿ ಪರಿಶೀಲಿಸಿದೆ
[Signature]
ಪಂಚಾಯತ್ ಅಧ್ಯಕ್ಷರು
ಬೆಂಗಳೂರು ದಕ್ಷಿಣ ತಾಲ್ಲೂಕು
ಬೆಂಗಳೂರು.

[Signature]
5/5/2024
ಭೂಮಾನಂದ ಸಹಾಯಕ ನಿರ್ದೇಶಕರು,
ಬೆಂಗಳೂರು ದಕ್ಷಿಣ ತಾಲ್ಲೂಕು,
ಬೆಂಗಳೂರು.