

Kodige Singaandra

VILLAGE: SHINGASANDRA

HOBLI: BEGUR

TALUK: BENGALURU SOUTH

DISTRICT: BENGALURU URBAN

Survey Number 69 (Buffer Zone)

(Buffer Zone Sketch (30 meter from lake boundary) prepared, as per the Order of HON'BLE HIGH COURT vide W.P NO: 38401/2014(PIL) Dated: 02-06-2021)

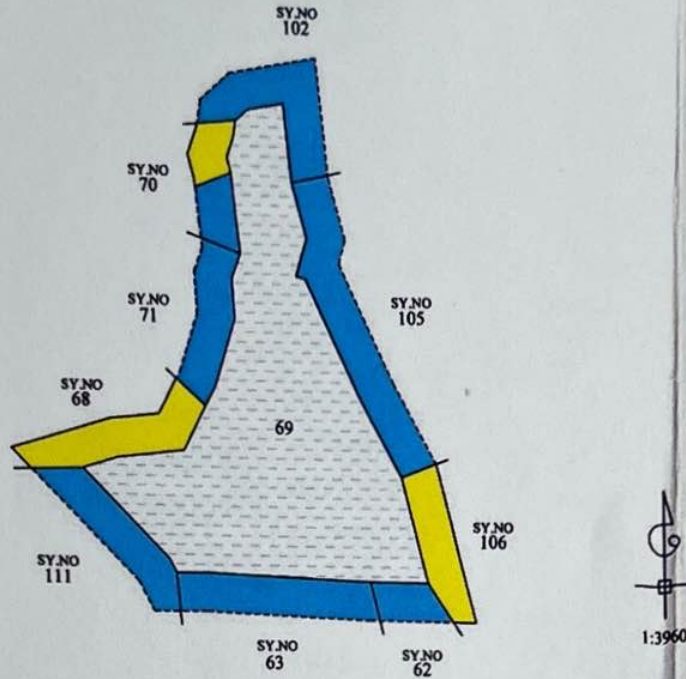

DETAILS:-

1. Sketch prepared, as per the directions of DDLR letter NO: ಜತಾಂಸ/ಭೂಲನಿ/ತಾಂ(6) ವಿವ:21/2021 ದ:28-06-2021 and memo of ADLR, Bangalore South NO: ಭೂ.ಸನಿ/ಪೋಡಿ/ಇತರೆ/273/2020-21, ದ: 02-05-2024
2. Shows developed area in the buffer area (The developed area contain Houses And road etc and revenue records details need to be verify from concerned authority).
3. Shows Vacant Land in Buffer Area.
4. Line shows the boundary of the lake.
5. line shows the boundary of the BUFFER ZONE area (30 meter from the boundary of the lake).
6. Survey department (land records) is only responsible for measurement and extent of the lake.
7. The measurement carried as per survey records in presence of B.B.M.P Engineer.
8. Buffer zone details as below:

SL.NO	LAKE S.NO	EXTENT OF THE LAKE		TOTAL EXTENT OF BUFFER ZONE (A-G)	VACANT AREA IN BUFFER ZONE (A-G)	DETAILS OF THE DEVELOPED AREA IN BUFFER ZONE		S.NO DETAILS IN BUFFER ZONE	REMARKS
		AS PER AKHARABAND (A-G)	AS PER MEASUREMENT (A-G)			Details	Extent (A-G)		
1	69	10-23	10-23	09-03	06-31	HOUSES AND ROAD	02-12	Shingasandra Sy.no :- 62,63,68,70,71,102,105,106,111	

Measurement Carried Date:- 16-5-2024

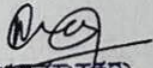
 ಭೂಮಿಮಾಪಕರು
 ಬೆಂಗಳೂರು ದಕ್ಷಿಣ ಅಲ್ಯೂಟಿ
 ಬೆಂಗಳೂರು.

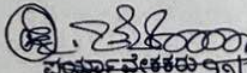
 ಭೂಮಿಮಾಪಕರು
 ಬೆಂಗಳೂರು ದಕ್ಷಿಣ ಅಲ್ಯೂಟಿ
 ಬೆಂಗಳೂರು

 ಭೂಮಿಮಾಪಕರ ಸಹಾಯಕ ನಿರ್ದೇಶಕರು,
 ಬೆಂಗಳೂರು ದಕ್ಷಿಣ ಅಲ್ಯೂಟಿ,
 ಬೆಂಗಳೂರು.