

Singasandra Lake

VILLAGE: SINGASANDRA HOBBI: BEGUR TALUK: BENGALURU SOUTH DISTRICT: BENGALURU URBAN

LAKE Survey Number: 99

(Lake Sketch prepared, as per the Order of HON'BLE HIGH COURT vide W.P NO: 6961/2020 Dated: 15-06-2021)

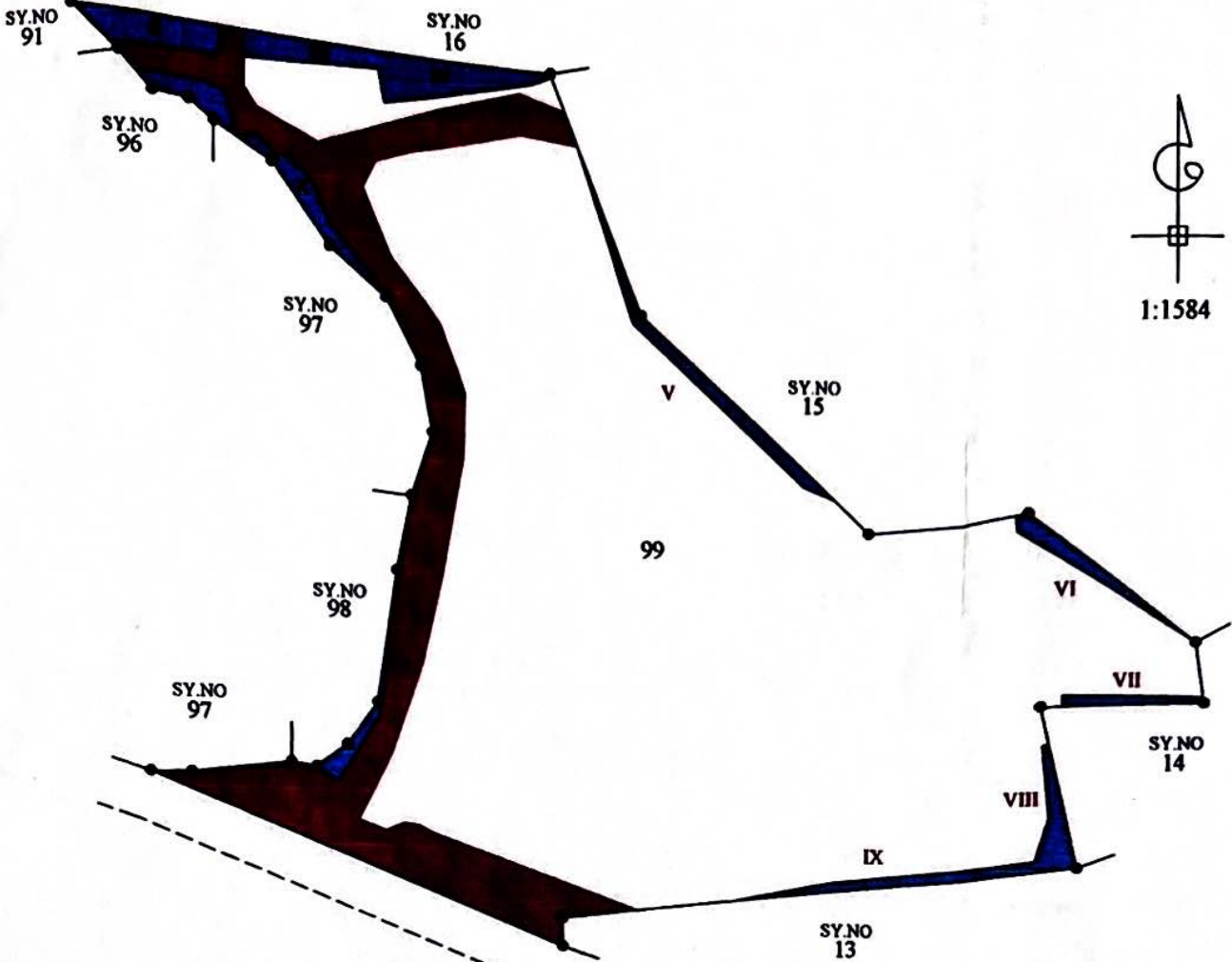

DETAILS:-

1. Sketch prepared, as per the directions of DDLR letter NO: ಜಿ.ಕಾಂ.ಸಂ/ಭೂ.ಸಂ/ಕಾಂ(6) ವಿ.ನಂ:21/2021 ದಿ:28-06-2021 and memo of ADLR, Bangalore South NO: ಭೂ.ಸಂ/ಬಿ.ಎ.ಡಿ/ಇ.ಸಂ/273/2020-21, ದಿ: 02-05-2024
2. Colour Shows the government encroachment details.
3. Colour Shows the private encroachment details.
4. Survey department (land records) is only responsible for measurement and extent of the lake.
5. The measurement carried as per survey records in presence of B.B.M.P Engineer.
6. As fencing of the lake boundary is already done by BBMP as per previous survey sketch during present field inspection that fence (chain And link fencing) is still in extents only leftout area of the lake is now demarketed as encroachment as per survey document.
7. Lake details as below. (The details of the encroachment in lake are need to be verify from concerned authority).

SL.NO	LAKE S.NO	EXTENT OF THE LAKE		DETAILS OF THE ENCHROCHMENT IN LAKE							REMARKS
		AS PER AKHARABAND (A-G)	AS PER MEASUREMENT (A-G)	PRIVATE ENCHROCHMENT			GOVT ENCHROCHMENT			VACANT LAND (A-G)	
				TYPE OF ENCHROCHMENT	BLOCK NO	EXTENT (A-G)	TYPE OF ENCHROCHMENT	BLOCK NO	EXTENT (A-G)		
1	99	10-14	10-14	Vacant Site	II	00-03.50	Road	I	01-20	08-07	
				Vacant Site	III	00-02.50					
				Parking	IV	00-04.50					
				Shed, Parking	V	00-03.50					
				Vacant Site	VI	00-02					
				Kaluve	VII	00-01					
				Kaluve	VIII	00-02					
				Tower, Burial Ground	IX	00-03					
				Building	X	00-05					

Measurement Carried Date:- 20.5.2024

(Signature)
ಭೂಮಿ ಸಂಪನ್ಮೂಲ
ಬಿ.ಬಿ.ಎಂ.ಪಿ. ಇಂಜಿನಿಯರ್,
ಬೆಂಗಳೂರು.

(Signature)
ಬಿ.ಬಿ.ಎಂ.ಪಿ. ಇಂಜಿನಿಯರ್,
ಬೆಂಗಳೂರು.

(Signature)
ಭೂಮಿ ಸಂಪನ್ಮೂಲ ಸಹಾಯಕ ನಿರ್ದೇಶಕರು,
ಬೆಂಗಳೂರು ದಕ್ಷಿಣ ಅಲ್ಪಸ್ಥಳ,
ಬೆಂಗಳೂರು.