

MALLATHAHALLI Lake Survey Number: 6, 26, 101

{Lake Sketch prepared, as per the Order of HON'BLE HIGH COURT vide W.P NO: 38401/2014(PIL) & CW WRIT Application Number:- 11044/2018 Dated: 04-09-2023}

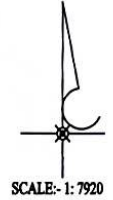
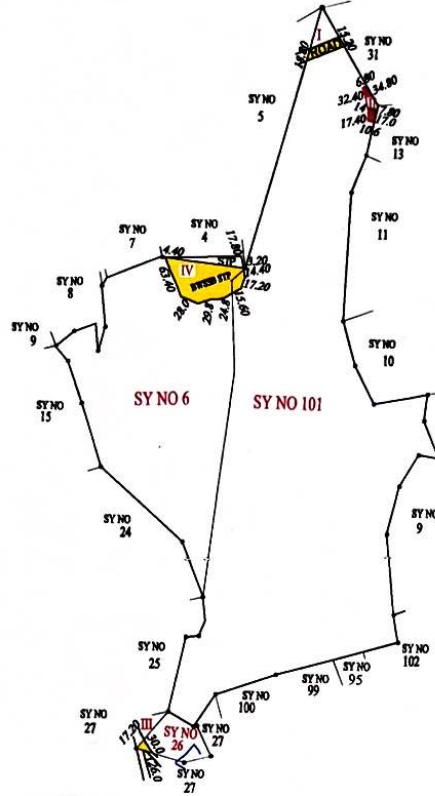

DETAILS:-

1. Sketch prepared, as per the directions of DDLR letter NO: ಜಿಆಂಸ/ಭೂಉನಿ/ಆಂ(6)ವಿವ:21/2020-21, ದಿ:20-09-2023 and memo of ADLR, Bangalore North NO: ಭೂ.ಸನಿ/ಪೋಡಿ/ಇತರೆ - 21 /2021-22, ದಿ:17-10-2023.
2. In sketch from block no I to IV hows the fact of the lake. (The developed area may contain layout roads, apartments, agriculture, buildings etc, and revenue records details need to be verifying from concerned authority).
3. ■ Color shows the privet encroachment details.
4. ■ Color shows the government encroachment details.
5. Survey department (land records) is only responsible for measurement and extent of the lake.
6. The measurement carried out in presence of Lake Development authority staff, revenue inspector, village accountant, by using E.T.S instrument.
7. Lake details as below:

SL.NO	Name of the Lake	LAKE SY.NO	BLOCK NO	EXTENT OF THE LAKE		DETAILS OF THE ENCHROCHMENT IN LAKE				VACANT LAND (A-G)	REAMARKS
				AS PER AKHARABAND (A-G)	AS PER MEASUREMENT (A-G)	PRIVATE ENCHROCHMENT		GOVT ENCHROCHMENT			
						TYPE OF ENCHROCHMENT	EXTENT (A-G)	TYPE OF ENCHROCHMENT	EXTENT (A-G)		
1		101	I	50-38	49-24	-	-	ROAD	0-08	49-10	
			II			-	-	-	-		
2		26	III	01-09	01-09	-	-	ROAD	0-03	01-06	
3		6	IV	20-08	20-25	-	-	BWWSSB, STP	1-15	19-10	

(Signature)
 ವೆಂಕಟೇಶ್.ಬಿ.ಎನ್
 ಭೂಮಾಪಕರು
 ಬೆಂಗಳೂರು ಉತ್ತರ ತಾಲ್ಲೂಕು

(Signature)
 ಬಯರ್ ವೆಂಕಟೇಶ್
 ಬೆಂಗಳೂರು ಉತ್ತರ ತಾಲ್ಲೂಕು

(Signature)
 ಪೊದಾಖಲೆಗಳ ಸಹಾಯಕ ನಿರ್ದೇಶಕರು
 ಬೆಂಗಳೂರು ಉತ್ತರ ತಾಲ್ಲೂಕು
 ಬೆಂಗಳೂರು ನಗರ ಜಿಲ್ಲೆ